

WARNING

Using any earphone at high volumes can permanently damage your hearing. Ringing in your ears or any other discomfort may indicate that the volume is too high. Always turn the volume down on your music source for your Jerry Harvey Audio™ Custom IEM before inserting the earpieces into your ears. Once both earpieces are in place, gradually increase the volume to a moderate level.

HEARING PROTECTION



This website uses cookies

We use cookies to personalise content and ads, to provide social media features and to analyse our traffic. We also share information about your use of our site with our social media, advertising and analytics partners who may combine it with other information that you've provided to them or that they've collected from your use of their services.

Necessary



Preferences



Statistics



Marketing



[Show details](#) >

Allow all

Allow selection

Deny

osna.gov

1. If you experience any discomfort or pain while wearing Jerry Harvey Audio™ Custom IEMs, remove them immediately.
2. Consult an audiologist or physician if you develop hearing problems, excessive wax build-up or any discomfort after use.
3. Do not submerge your Jerry Harvey Audio™ Custom IEM or expose it to water.

INSERTING THE EARPIECES

Your Jerry Harvey Audio™ Custom IEM was handcrafted to fit snugly and comfortably in your ears. To maximize your comfort and to optimize your listening experience, it's important to insert the earpieces properly. For your convenience, your Jerry Harvey Audio™ Custom IEM is marked with blue lettering to indicate the left earpiece and red lettering to indicate the right earpiece.

1. **STEP 1** - Turn the output volume all the way down on the device you'll be listening to through your Jerry Harvey Audio™ Custom IEM. ALWAYS decrease the volume BEFORE listening to any audio source.
2. **STEP 2** - Roll the IEM forward about a quarter turn, and carefully slide the sound bore into your ear canal.
3. **STEP 3** - Gently roll the earpiece backwards into your ear and push on the faceplate to create a secure seal.

4. **STEP 4** - Wrap cable up and behind each ear. Adjust plastic connector sleeve as needed for desired fit.



Cookiebot
by Usercentrics

This website uses cookies

We use cookies to personalise content and ads, to provide social media features and to analyse our traffic. We also share information about your use of our site with our social media, advertising and analytics partners who may combine it with other information that you've provided to them or that they've collected from your use of their services.

Necessary



Preferences



Statistics



Marketing



[Show details](#) >

ATTACHING YOUR CABLE

Your Jerry Harvey Audio™ Custom IEM was designed with a cable that can be replaced in the field.

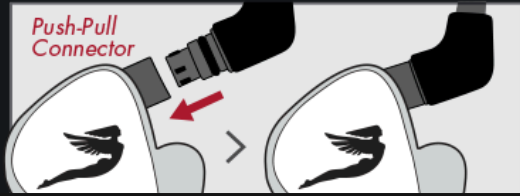
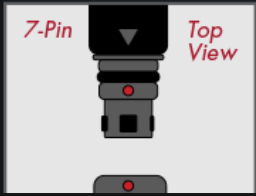
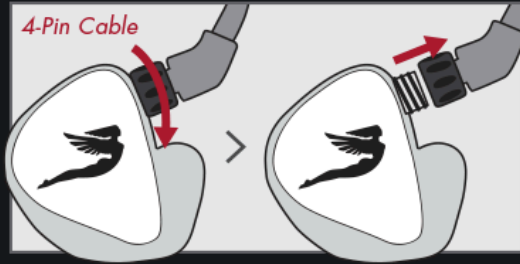
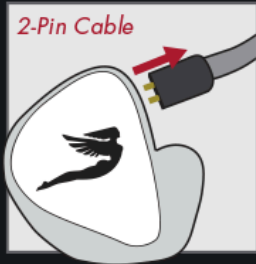

Cookiebot
by Usercentrics

This website uses cookies

We use cookies to personalise content and ads, to provide social media features and to analyse our traffic. We also share information about your use of our site with our social media, advertising and analytics partners who may combine it with other information that you've provided to them or that they've collected from your use of their services.

Necessary



Preferences



Statistics



Marketing



[Show details](#) >



CUSTOM +

UNIVERSAL +

OUR COMPANY +

SUPPORT +

ACCOUNT +

POLICIES +

© 2026 Jerry Harvey Audio LLC™. All Rights Reserved. The FLY GIRL logo is a registered trademark of Jerry Harvey Audio LLC™.



This website uses cookies

We use cookies to personalise content and ads, to provide social media features and to analyse our traffic. We also share information about your use of our site with our social media, advertising and analytics partners who may combine it with other information that you've provided to them or that they've collected from your use of their services.

Necessary



Preferences



Statistics



Marketing



[Show details](#) >